

FOOTPEG ASSY (TL4000)

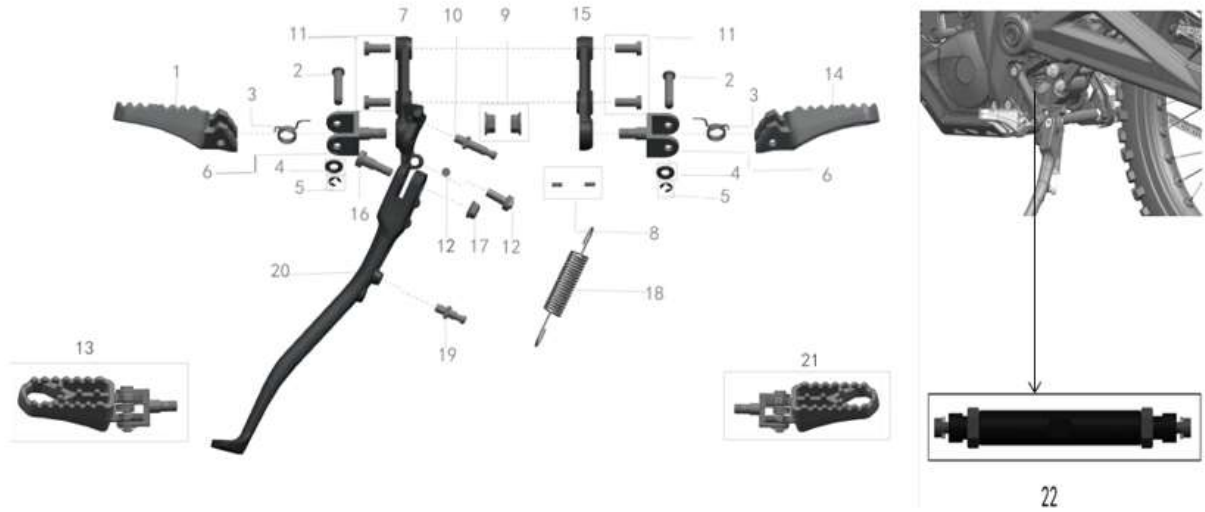

FOOTPEG ASSY (TL4000)

| Item | Parte Ref. No. | Descripción | Unit | Precio (CLP) |
|------|-----------------|---------------------------------|------|--------------|
| 1 | 40620-56000-000 | L. Footpeg | Pcs | \$ 30.000 |
| 2 | 43644-56000-000 | Footpeg Fixing Pin (Φ13*Φ8*41) | Pcs | \$ 5.500 |
| 3 | 11802-56000-000 | Footpeg Return Spring | Pcs | \$ 6.000 |
| 4 | 10724-56000-000 | Washer (Φ8*Φ18*1.5) | Pcs | \$ 3.500 |
| 5 | 10782-56000-000 | Circlip (inner diameter Φ6) | Pcs | \$ 3.500 |
| 6 | 40621-56000-000 | Footpeg connector | Pcs | \$ 18.000 |
| 7 | 40622-56000-000 | L. Footpeg Holder | Pcs | \$ 25.500 |
| 8 | 43643-56000-000 | Dowel Pin (Φ4*10) | Pcs | \$ 7.000 |
| 9 | 10044-56000-000 | Nut GB/T6187.1 (M10*1.25) | Pcs | \$ 3.500 |
| 10 | 40327-56000-000 | Side Kickstand Spring Pin | Pcs | \$ 5.000 |
| 11 | 10525-56000-000 | Bolt DIN (M8*25) | Pcs | \$ 3.500 |
| 12 | 50200-56000-000 | Side Kickstand Power-Off Switch | Set | \$ 14.000 |
| 13 | 40620-5600Z-000 | L. Footpeg Assy. | Set | \$ 40.500 |
| 14 | 40640-56000-000 | R. Footpeg | Pcs | \$ 17.000 |
| 15 | 40642-56000-000 | R. Footpeg Holder | Pcs | \$ 25.500 |
| 16 | 40324-56000-000 | Screw (M8*30) | Pcs | \$ 7.500 |
| 17 | 10043-56000-000 | Nut GB/T6187.1 (M8) | Pcs | \$ 3.500 |
| 18 | 11402-56000-000 | Side Kickstand Spring | Pcs | \$ 3.500 |
| 19 | 40328-56000-000 | Side Kickstand Spring Pin B | Pcs | \$ 5.000 |
| 20 | 40320-56000-000 | Side Kickstand | Pcs | \$ 28.000 |
| 21 | 40640-5600Z-000 | R. Footpeg Assy. | Set | \$ 40.500 |
| 22 | 40650-56000-000 | Braces | Set | \$ 25.000 |